





































Saldanha

PALMS-II

CANDOLIM



Candolim, North Goa

SALDANHA PALMS



SALDANHA PALMS 2 PRICE LIST

TYPE	SIZE (SQFT)	PRICE (SQFT) (RS.)	AMOUNT (RS.)	BOOKING
Studio+Terrace - B	876.94	On Request	88.89 Lacs	20%
1 BR - B	876.90	On Request	91.20 Lacs	20%
2 BR+Terrace - B	968.08	On Request	99.81 Lacs	20%
2 BR+Terrace - A	999.60	On Request	91.35 Lacs	20%
2 BR - B	1008.79	On Request	91.28 Lacs	20%
2 BR+Terrace - A	1048.29	On Request	94.87 Lacs	20%
2 BR - A	1066.27	On Request	92.80 Lacs	20%
2 BR - A	1112.62	On Request	98.21 Lacs	20%

SALDANHA PALMS 2 OVERVIEW

- ✦ Designer tiles for bathrooms, coloured sanitaryware & hot/cold arrangement.
- ✦ Teak wood pannelled main door with brass fittings other & doors to be of teak wood frame with marine ply panels
- ✦ Interiors with acrylic distemper & Exteriors with weather protective Paints



Typical Upper Ground & Second Floor Plan

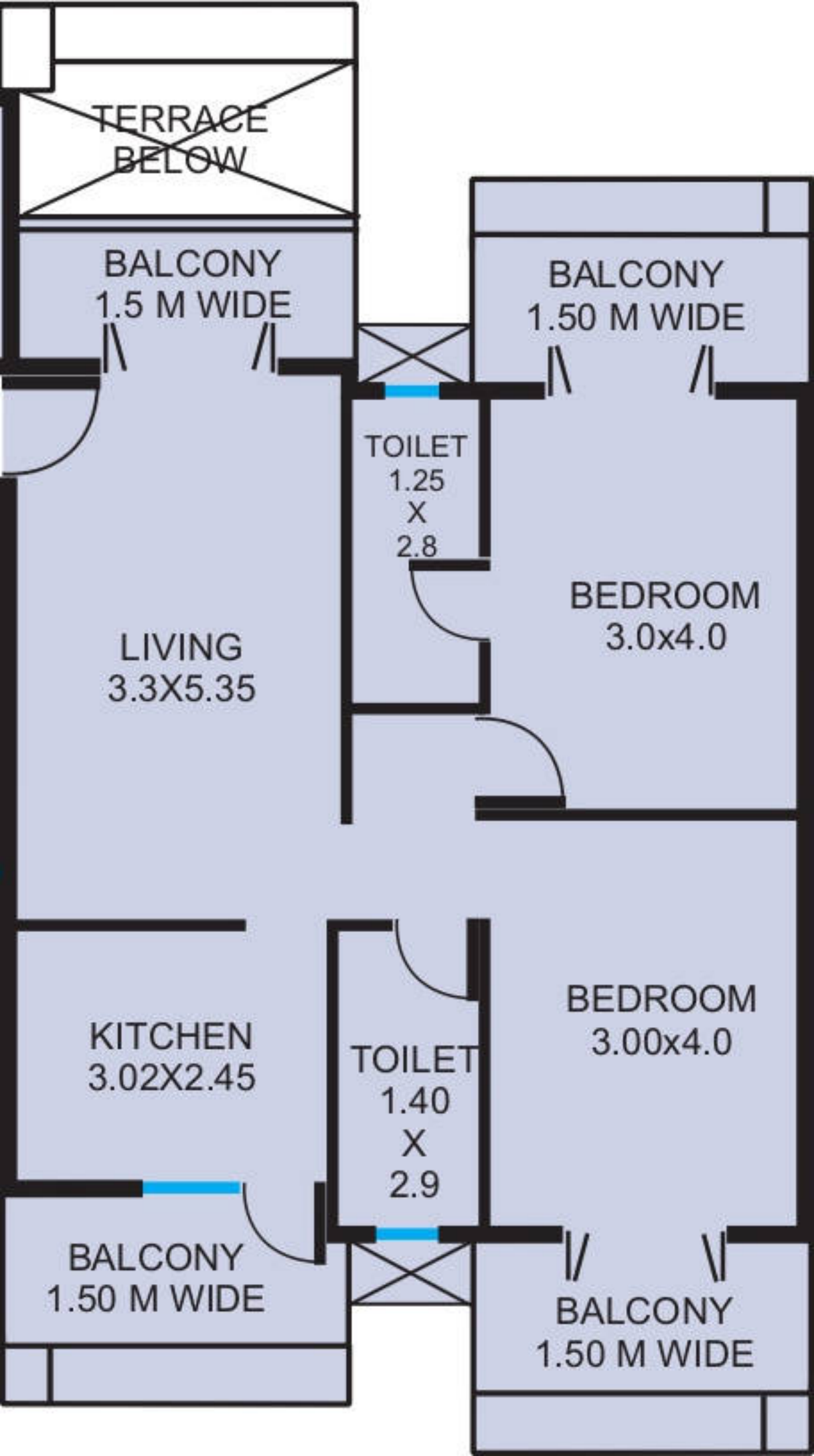

TERRACE
BELOW

BALCONY
1.5 M WIDE

LIVING
3.3X5.35

KITCHEN
3.02X2.45

BALCONY
1.50 M WIDE

BALCONY
1.50 M WIDE

TOILET
1.25
X
2.8

BEDROOM
3.0x4.0

TOILET
1.40
X
2.9

BEDROOM
3.00x4.0

BALCONY
1.50 M WIDE

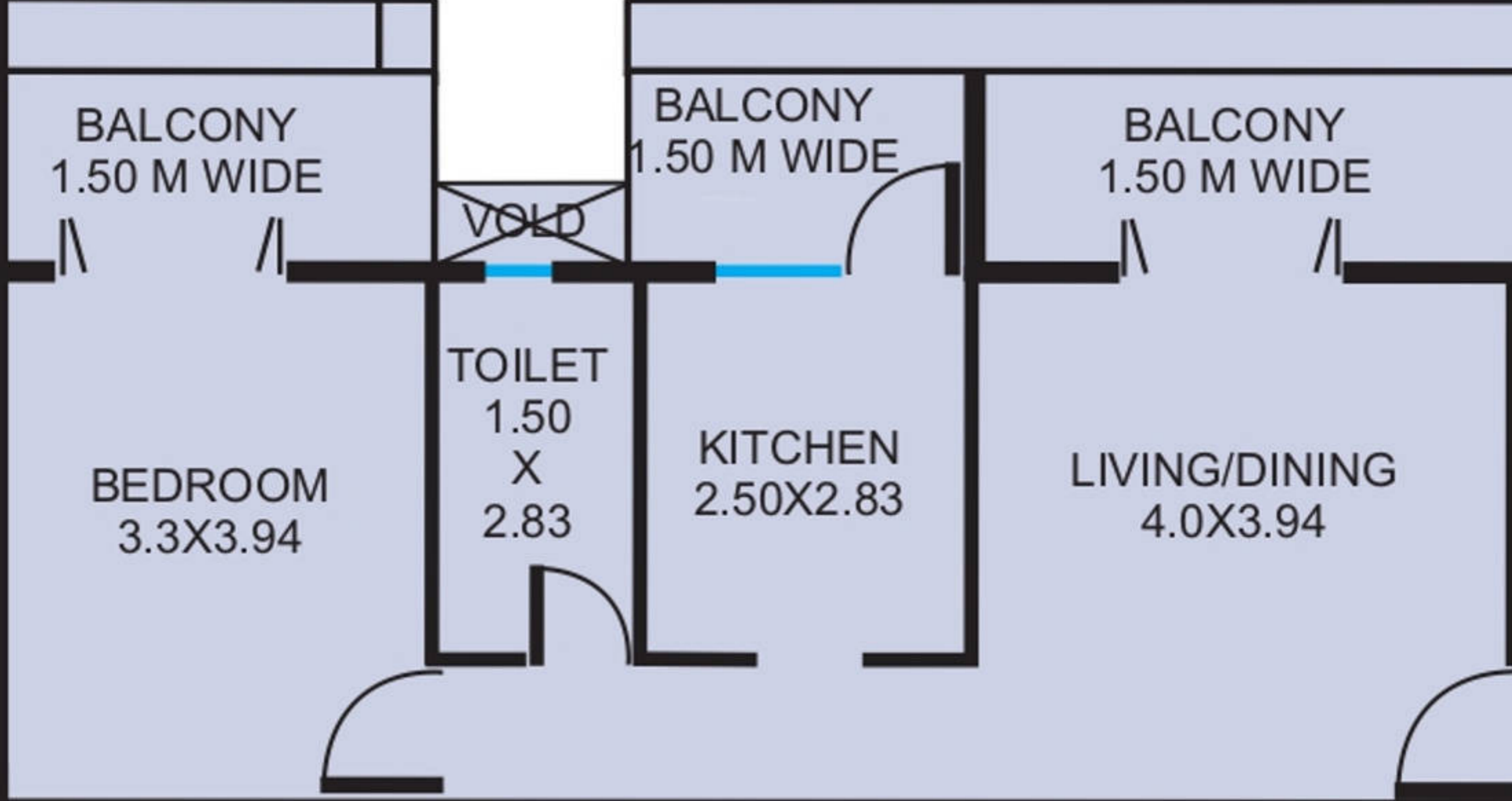

BALCONY
1.50 M WIDE

BALCONY
1.50 M WIDE

BALCONY
1.50 M WIDE

VOID

BEDROOM
3.3X3.94

TOILET
1.50
X
2.83

KITCHEN
2.50X2.83

LIVING/DINING
4.0X3.94

LOCATION MAP OF SALDANHA PALMS 2

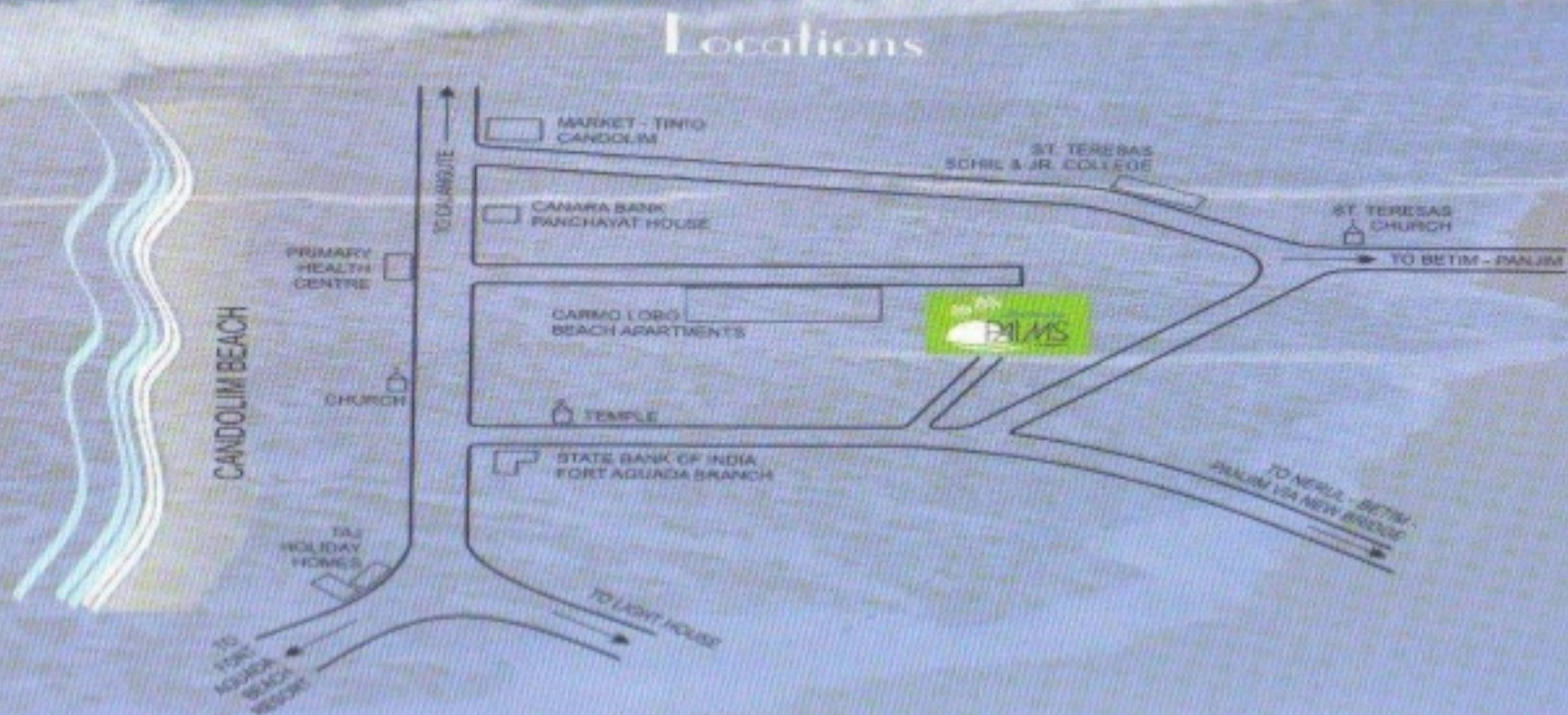



SITE PLAN